



# 川南妇女儿童医院内装初步设计方案

Preliminary interior design plan of Sichuan South Women and Children's Hospital  
2021-01

# 目 录

01

接待大厅

02

医疗街

03

门诊

04

中庭

05

病房部分

# *01 接待大厅*

---



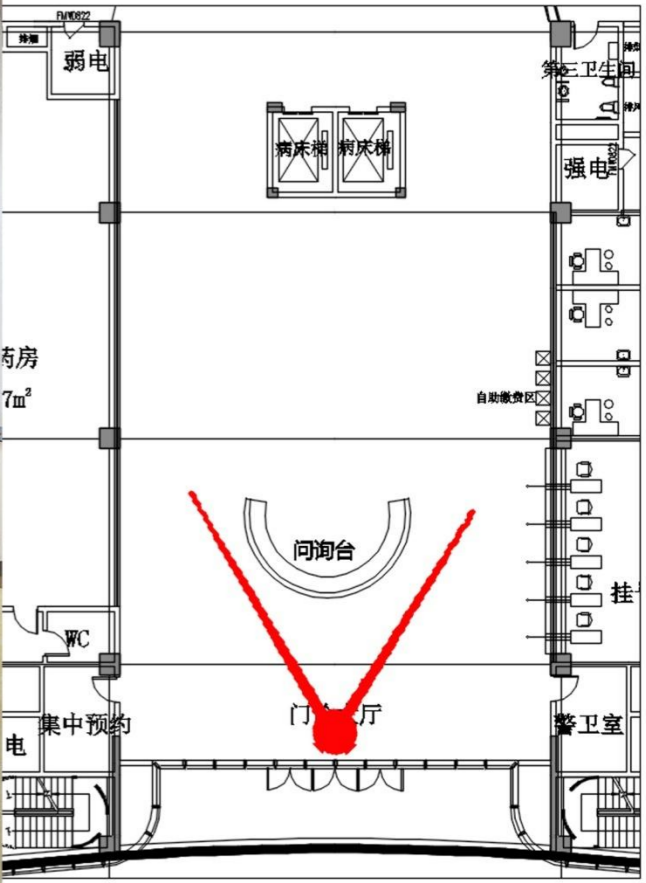



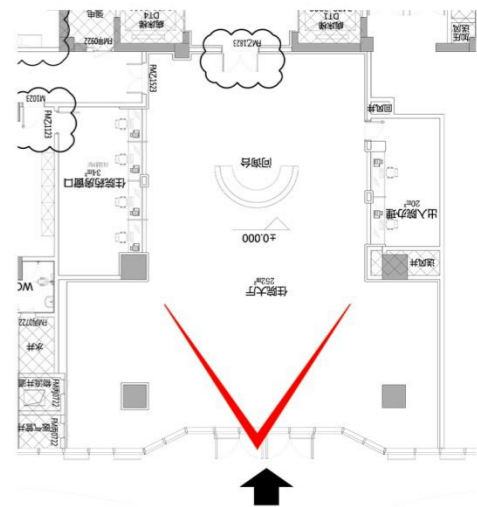



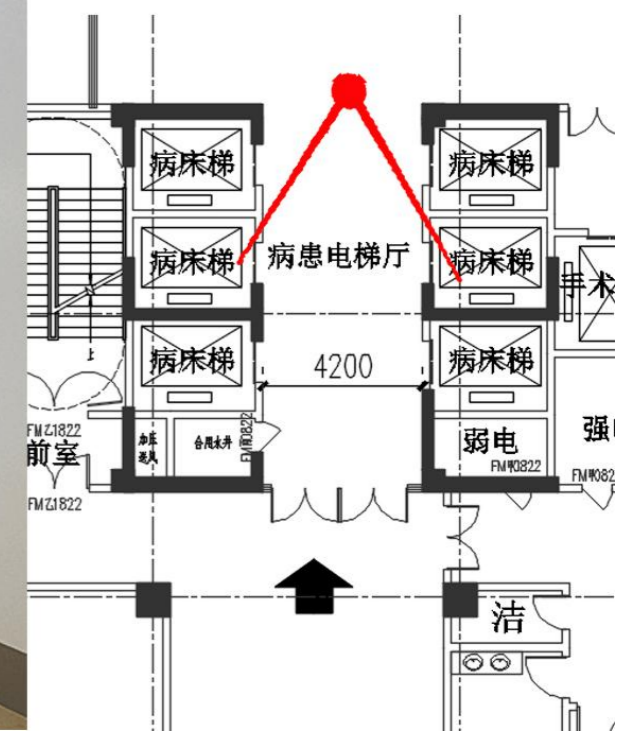



## 02 医疗街

---



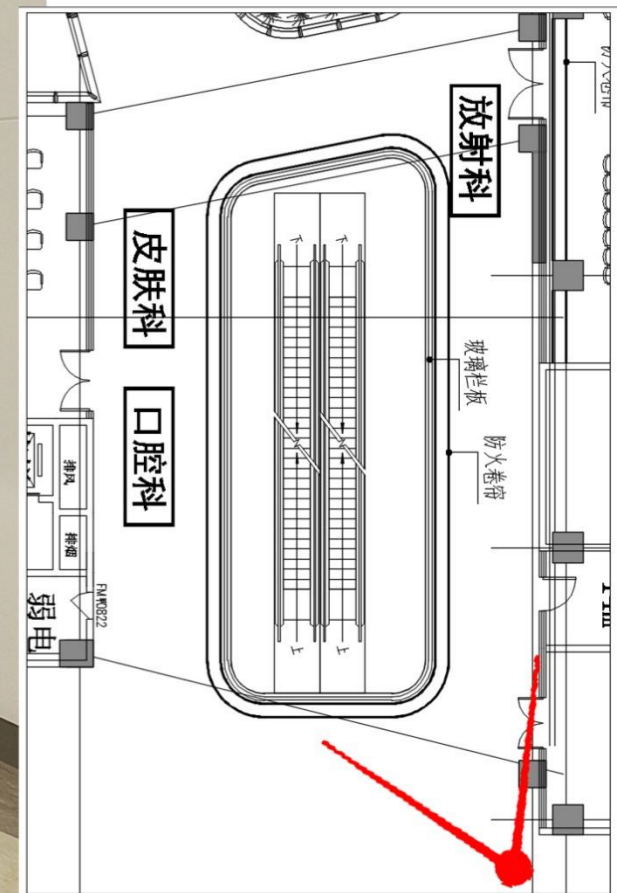



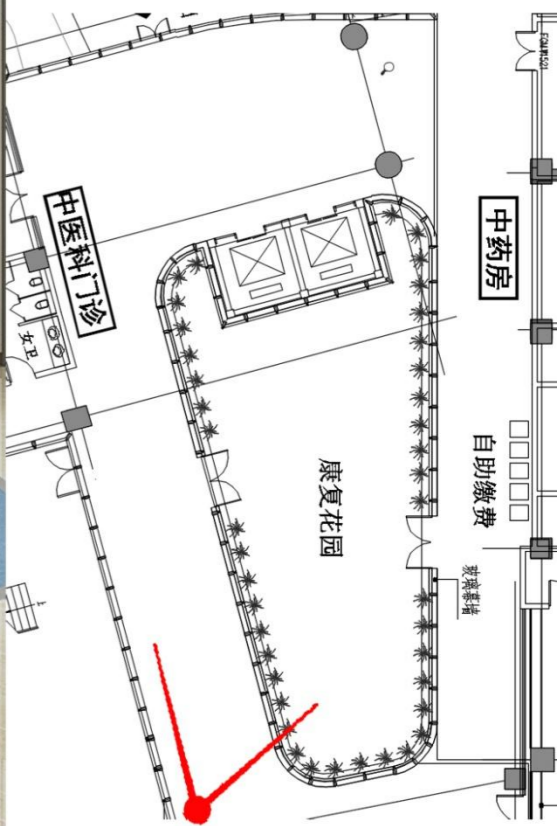



## 03 门诊

---



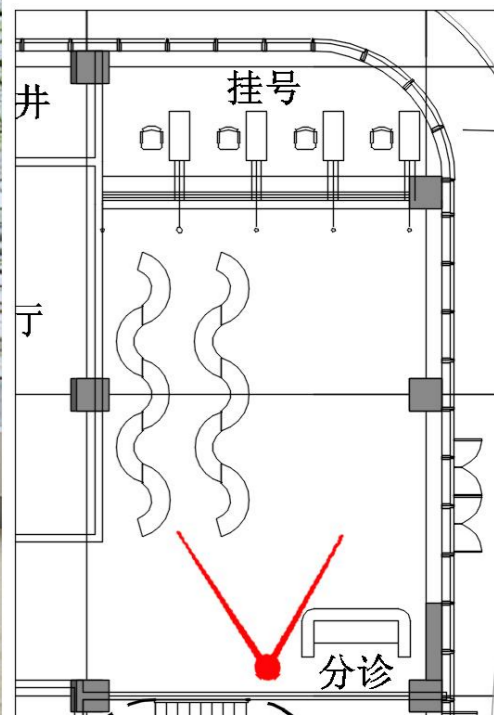



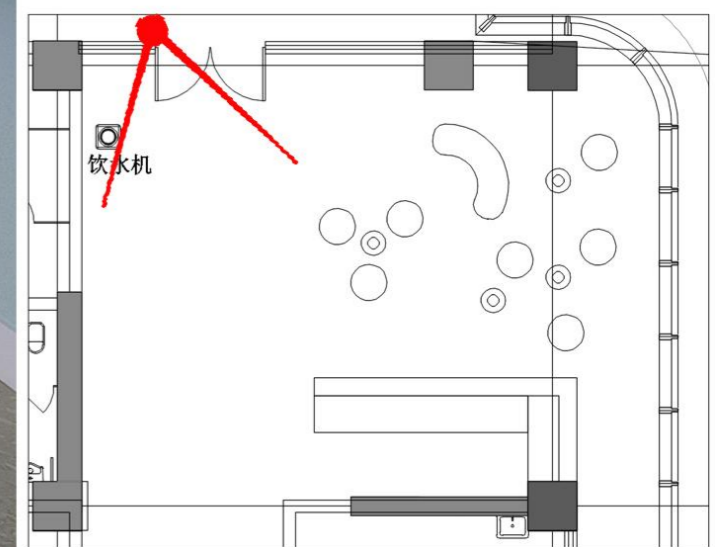



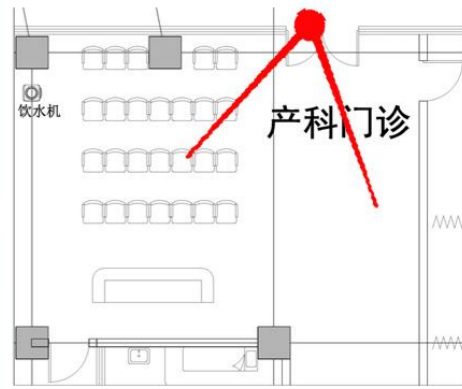



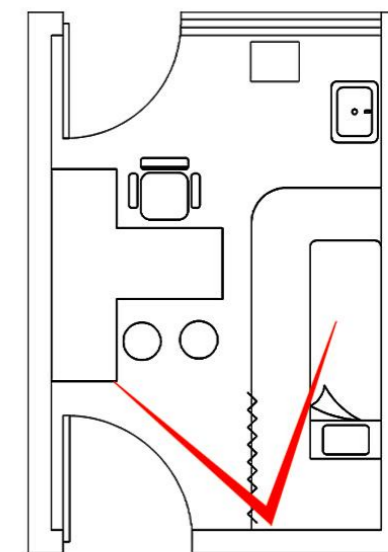

## 04 中庭

---



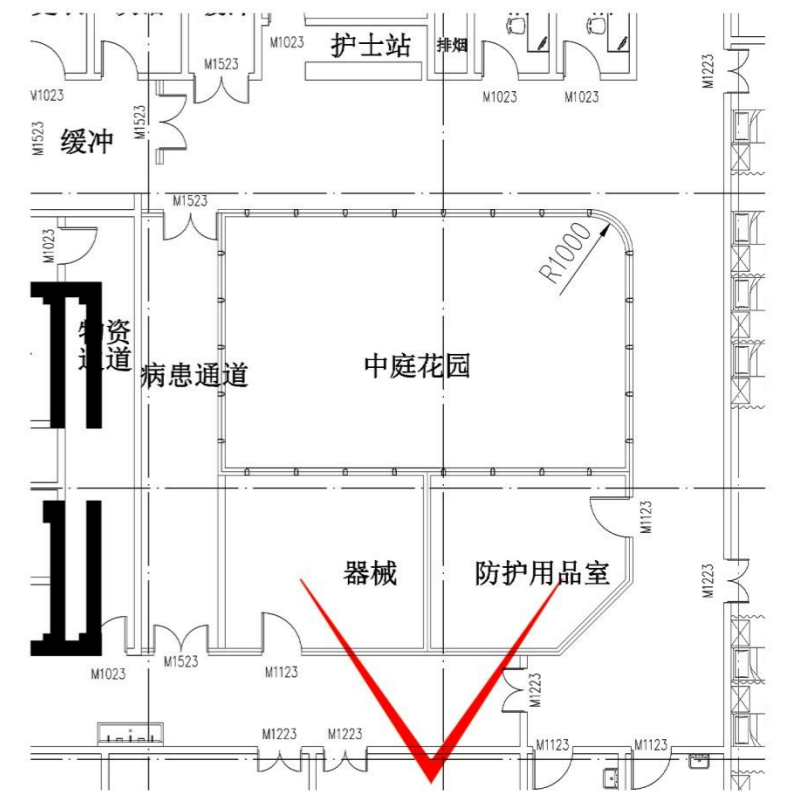



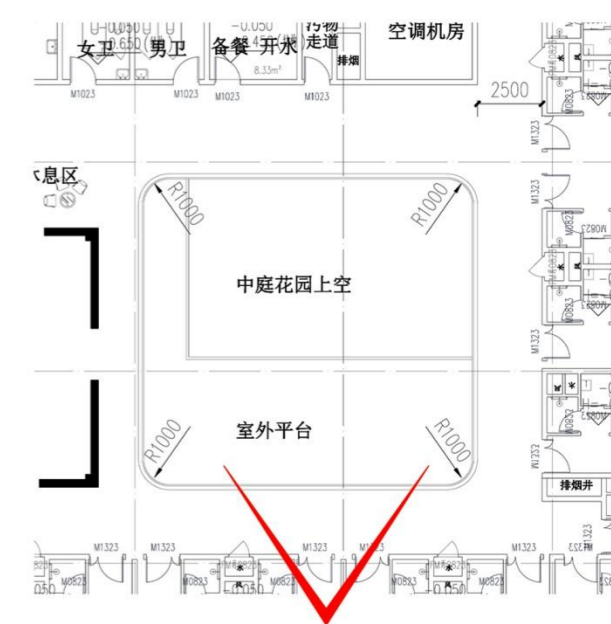



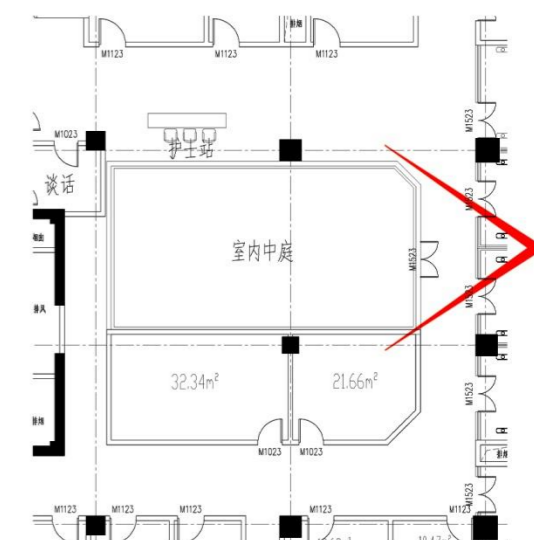



## ***05 病房部分***

---











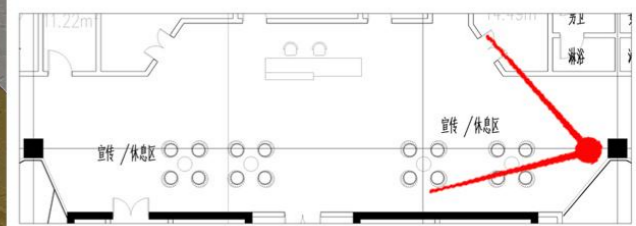



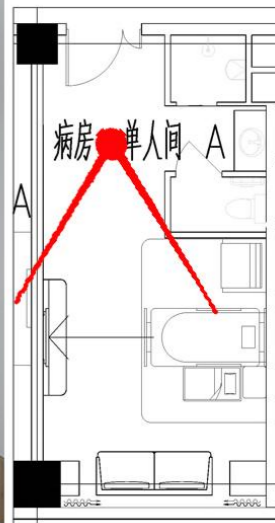



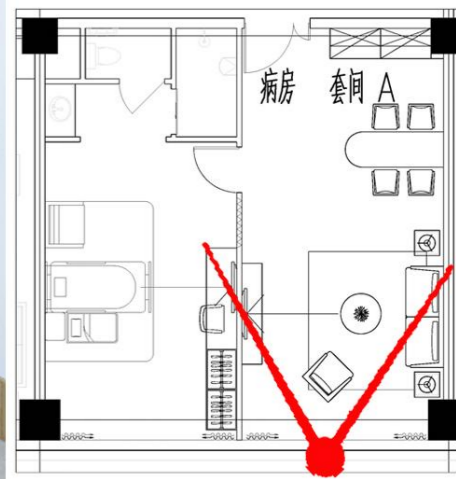



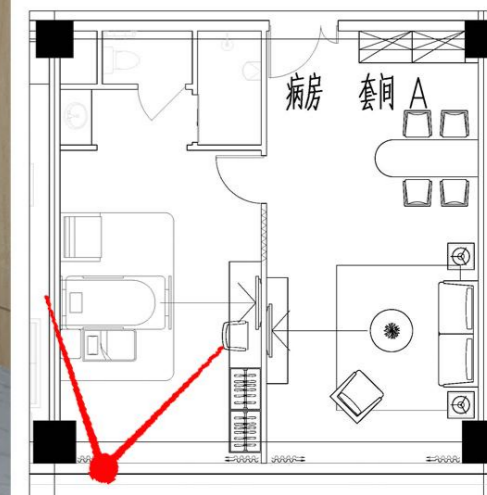







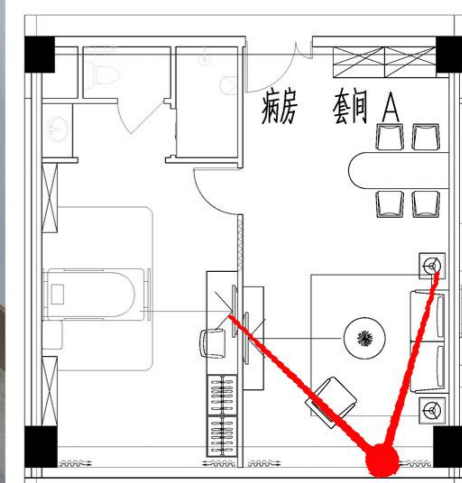



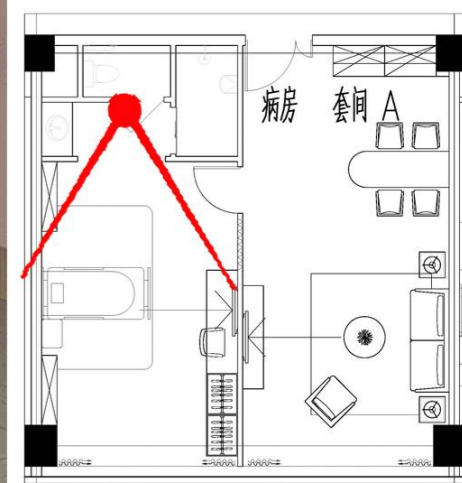



**THANKS**

